

**Wally Burns**  
Mayor

wburns@cityofsouthside.com  
Office: 256-442-9775 Ext. 101  
Fax: 256-442-9763



**Cynthia B. Osborne**  
City Clerk

cityclerk@cityofsouthside.com  
Office: 256-442-9775 Ext. 102  
Fax: 256-442-9763

2255 Highway 77 • Southside, Alabama 35907  
[www.cityofsouthside.com](http://www.cityofsouthside.com)

February 25, 2020

To whom it may concern:

Please find enclosed Ordinance #0-002-2020 which amended Ordinance 0-001-2020 that was previously sent to your agency from the City of Southside. When Ordinance #0-001-2020 was adopted on January 13<sup>th</sup>, 2020 annexing in 93.82 acres of property the city failed to put in Ordinance #0-001-2020 that not only would the ordinance change the city limits, but it would also change the Police Jurisdiction of the city of Southside; Therefore the city adopted Ordinance 0-002-2020 amending Ordinance 0-001-2020 by adding in Section 6 which also extends the police jurisdiction of the city of Southside to include the 93.82 acres of property recently annexed into the city of Southside.

The city of Southside understands the police jurisdiction cannot be enforced until after January 1, 2021. A copy of the ordinance amendment has been sent to Atlas Alabama and various other agencies.

Ordinance 0-002-2020 was recorded at the Calhoun County Court house on 2/25/2020 Book 3260 page 884. Ordinance 0-001-2020 was recorded at the Calhoun County Court house on 1/24/2020 Book 3259 page 569.

If there should be any questions about either of the ordinances please contact Cynthia B. Osborne, City Clerk at 256-442-9775 Extension 102 or [cityclerk@cityofsouthside.com](mailto:cityclerk@cityofsouthside.com)

Signed this the 25<sup>th</sup> day of February, 2020.

  
Cynthia B. Osborne, City Clerk

**Danny L. Garnett**  
Council  
Place No. 1

**John Hatley**  
Council  
Place No. 2

**Joey Jones**  
Council  
Place No. 3

**Don Steward**  
Council  
Place No. 4

**Dana Synder**  
Council  
Place No. 5

ORDINANCE 0-002-2020

CITY OF SOUTHSIDE  
COUNTY OF ETOWAH  
STATE OF ALABAMA

AN ORDINANCE AMENDING ORDINANCE 0-001-2020 WHICH ANNEXED 93.82 ACRES  
OF PROPERTY INTO THE CITY LIMITS OF THE CITY OF SOUTHSIDE  
THIS ORDINANCE AS PRESENTED **WILL AMEND ORDINANCE 0-001-2020 BY ADDING "SECTION 6" TO  
ORDINANCE 0-001-2020 DECLARING THE PROPERTY ANNEXED  
WILL ALSO BE EXTENDING THE POLICE JURISDICTION OF THE CITY OF SOUTHSIDE, ALABAMA**

WHEREAS, on January 13<sup>th</sup>, 2020 the Southside City Council did adopt Ordinance #0-001-2020 annexing into the city limits of the city of Southside, Alabama 93.82 acres of property located in Calhoun County. Said Ordinance 0-001-2020 was recorded at the Calhoun County Probate Office of Alice K. Martin on January 24, 2020 in book 3259 page 569 and;

WHEREAS, on January 13<sup>th</sup>, 2020 when Ordinance number 0-001-2020 was adopted the ordinance did not expressly indicate the extension of the city limits would include extending the Police Jurisdiction of the city of Southside, Alabama as required by Section 11-40-10 Code of Alabama 1975 and;

WHEREAS, Section 6 shall be added to Ordinance 0-001-2020 and will reflect the following:

SECTION 6. The police jurisdiction of the City of Southside, Alabama, be, and the same are hereby altered or rearranged so as to include all of the territory here to before encompassed by the corporate limits of the City of Southside, Alabama, and in addition thereto the following described territory, to wit:

LEGAL DESCRIPTION: BIG OAK RANCH, INC.

COMMENCE AT A PINCHED PIPE MARKING THE NW CORNER OF THE NW1/4-NW1/4 IN SECTION 26, T-13-S, R-6-E, THENCE S86°58'09"E 1216.18' TO A 3/4" PIPE ON THE WESTERLY R/W OF JAKE MINTZ ROAD (40' R/W), SAID POINT BEING THE POINT OF BEGINNING, THENCE ALONG SAID R/W THE FOLLOWING BEARINGS AND DISTANCES: THENCE N19°53'21"E 146.64' TO A 1/2" REBAR CAPPED(CA-497-LS), THENCE N15°09'55"E 166.16' TO A 3/4" PIPE, THENCE N12°14'06"E 92.18' TO A 3/4" REBAR, THENCE N05°59'11"E 57.08' TO A 1/2" REBAR CAPPED(CA-497-LS), THENCE N17°25'06"W 30.68' TO A 3/4" REBAR AT THE INTERSECTION OF THE WESTERLY R/W OF JAKE MINTZ ROAD (40' R/W) AND THE SOUTHERLY R/W OF GILBERT FERRY ROAD (50' R/W), THENCE ALONG SAID R/W OF GILBERT FERRY ROAD (50' R/W) N79°29'32"E 17.20' TO A MAGNETIC NAIL, THENCE LEAVING SAID R/W S00°22'06"E 289.43' TO A 1/2" REBAR CAPPED(CA-497-LS), THENCE S86°58'06"E 1345.46' TO A 1/2" REBAR, THENCE S86°58'06"E 559.58' TO A 1/2" REBAR, THENCE S86°57'53"E 575.74' TO A 1/2" REBAR, THENCE S86°57'53"E 210.00' TO A 1/2" REBAR CAPPED(CA-497-LS), THENCE S03°26'20"E 202.87' TO A 1 1/2" REBAR AT AN OLD FENCE LINE, THENCE ALONG SAID OLD FENCE LINE THE FOLLOWING CHORD BEARINGS AND DISTANCES: THENCE S15°15'38"W 221.40' TO A POINT, THENCE S09°31'55"W 206.19' TO A POINT, THENCE S01°04'38"W 697.64' TO A POINT, THENCE S01°31'28"E 159.20' TO A POINT, THENCE S02°08'46"E 80.87' TO A 1/2" REBAR AT A FENCE CORNER, THENCE LEAVING SAID OLD FENCE LINE N86°34'55"W 2594.16' TO A 1/2" REBAR CAPPED(CA-497-LS), THENCE N00°03'41"E 668.64' TO A 1/2" REBAR CAPPED(SKIPPER), THENCE N00°03'41"E 334.47' TO A 1/2" REBAR CAPPED(SKIPPER), THENCE N00°03'41"E 334.55' TO A 1/2" REBAR CAPPED(CA-497-LS), THENCE N82°27'47"W 100.47' TO A 1/2" REBAR ON THE EASTERLY R/W OF JAKE MINTZ ROAD (40' R/W), THENCE LEAVING SAID R/W N82°14'53"W 42.03' TO THE POINT OF BEGINNING, CONTAINING 93.82 ACRES MORE OR LESS. LESS AND EXCEPT ANY PORTION LYING WITHIN THE R/W OF JAKE MINTZ ROAD (40' R/W). Legal Description provided by Engineer Larry Walker.

**The territory described in this ordinance shall extend the Police Jurisdiction of the City of Southside, Alabama effective January 1, 2021 pursuant to Section 11-40-10 (d) (e) (f) Code of Alabama 1975.**

NOW THEREFORE ORDINANCE #0-002-2020 IS HEREBY ADOPTED AND AMENDS ORDINANCE 0-001-2020 TO EXTEND THE POLICE JURISDICTION OF THE CITY OF SOUTHSIDE, ALABAMA EFFECTIVE JANUARY 1, 2021. SIGNED THIS THE 24<sup>TH</sup> DAY OF FEBRUARY, 2020.

Wally Burrs  
Mayor Wally Burrs

Joey Jones  
Council Member: Joey Jones

Danny Garnett  
Council Member: Danny Garnett

Don Steward  
Council Member: Don Steward

John Hatley  
Council Member: John Hatley

Dana Snyder  
Council Member: Dana Snyder

ATTEST:

Cynthia B. Osborne  
Cynthia B. Osborne, City Clerk

**CERTIFICATION OF ADOPTION**

I hereby certify that the attached ordinance was duly adopted by the Southside City Council in regular session assembled on the 24<sup>th</sup> day of February, 2020 and is recorded in the official minutes of the Southside City Council.

Cynthia B. Osborne  
Cynthia B. Osborne, City Clerk

**CERTIFICATION OF PUBLICATION**

I, Cynthia B. Osborne, City Clerk for the City of Southside, Alabama, do hereby certify that this Ordinance was posted in four public places within the city, (Woody's Grocery, Southside Community Center, Southside Pharmacy and at the Southside City Hall, beginning on the 25<sup>th</sup> day of February, 2020 in accordance with the provisions of Code of Alabama, 1975, Section 11-45-8.

Date: 2/25/2020

Cynthia B. Osborne  
Cynthia B. Osborne, City Clerk

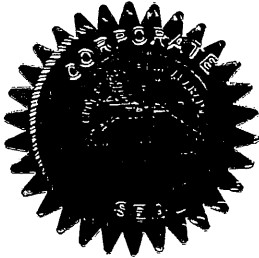

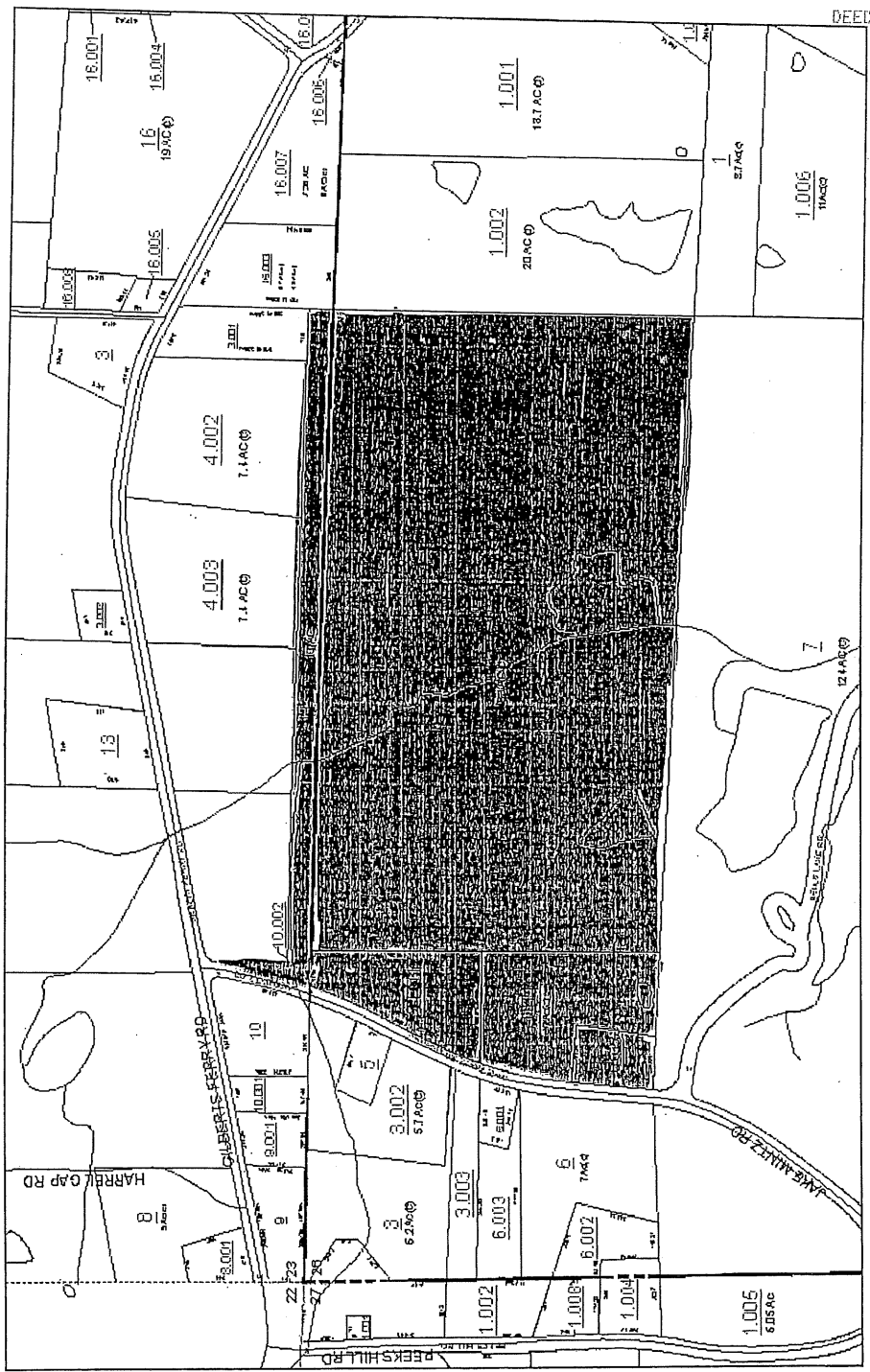

Owner Name: BIG OAK RANCH INC  
 PPIN: 36080  
 Parcel Number: 0506230000010002  
 Street Address: 0 BELLS LAKE RD



Provided by the Calhoun County  
 Revenue Commissioner  
 Mrs. Karen Roper  
 Maps to be used for tax purposes only -  
 Not to be used for conveyance  
 Map Data is in NAD 1983 State Plane  
 Alabama East Feet.

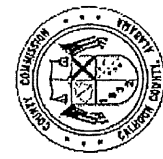

Mental Health Fee	4.00
Recording Fee	15.00
<b>TOTAL</b>	<b>19.00</b>

**ORDINANCE 0-001-2020**

**CITY OF SOUTHSIDE  
COUNTY OF ETOWAH  
STATE OF ALABAMA**

Mental Health Fee 4.00  
Recording Fee 12.00  
TOTAL 16.00

**AN ORDINANCE ASSENTING TO THE ANNEXATION  
OF PROPERTY OWNED BY BIG OAK RANCH, INC.**

**SAID PROPERTY 93.82 ACRES ARE LOCATED IN CALHOUN COUNTY  
AND ADJOINS CURRENT BIG OAK RANCH, INC. PROPERTY THAT IS IN  
THE CITY OF SOUTHSIDE CITY LIMITS**

WHEREAS, on the 28<sup>th</sup> day of October 2019 Robert Duke, CFO for Big Oak Ranch Inc. as Custodian of real property hereinafter described, did file with the City Clerk of the City of Southside, Alabama, a petition asking that the said described tract or parcel of land be annexed to and become a part of the City of Southside; and

WHEREAS, said petition did contain the signature of Robert L. Duke acting CFO of the Big Oak Ranch Inc. whom owns the described territory provided a map of said property showing the relationship to the corporate limits of the City of Southside, and

WHEREAS, the governing body did determine that it is in the public interest that said property be annexed to the City of Southside and it did further determine that all legal requirements for annexing said real property have been met pursuant to Sections 11-42-20 through 11-42-24, Code of Alabama, 1975;

**NOW, THEREFORE, BE IT ORDAINED BY THE CITY COUNCIL OF  
SOUTHSIDE, ALABAMA, AS FOLLOWS:**

Section 1. The Council of the City of Southside, Alabama, finds and declares as the legislative body of the city that it is in the best interests of the city, and the citizens of the affected area, to bring the territory described in Section 2 of this ordinance into the City of Southside.

Section 2. The boundary lines of the City of Southside, Alabama, be, and the same are hereby altered or rearranged so as to include all of the territory here to before encompassed by the corporate limits of the City of Southside, Alabama, and in addition thereto the following described territory, to wit:

**BIG OAK RANCH, INC.**

**LEGAL DESCRIPTION:**

COMMENCE AT A PINCHED PIPE MARKING THE NW CORNER OF THE NW1/4-NW1/4 IN SECTION 26, T-13-S, R-6-E, THENCE S86°58'09"E 1216.18' TO A 3/4" PIPE ON THE WESTERLY R/W OF JAKE MINTZ ROAD (40' R/W), SAID POINT BEING THE POINT OF BEGINNING, THENCE ALONG SAID R/W THE FOLLOWING BEARINGS AND DISTANCES: THENCE N19°53'21"E 146.64' TO A 1/2" REBAR CAPPED(CA-497-LS), THENCE N15°09'55"E 166.16' TO A 3/4" PIPE, THENCE N12°14'06"E 92.18' TO A 3/4" REBAR, THENCE N05°59'11"E 57.08' TO A 1/2" REBAR CAPPED(CA-497-LS), THENCE N17°25'06"W 30.68' TO A 3/4" REBAR AT THE INTERSECTION OF THE WESTERLY R/W OF JAKE MINTZ ROAD (40' R/W) AND THE SOUTHERLY R/W OF GILBERT FERRY ROAD (50' R/W), THENCE ALONG SAID R/W OF GILBERT FERRY ROAD (50' R/W) N79°29'32"E 17.20' TO A MAGNETIC NAIL, THENCE LEAVING SAID R/W S00°22'06"E 289.43' TO A 1/2" REBAR CAPPED(CA-497-LS), THENCE S86°58'06"E 1345.46' TO A 1/2" REBAR, THENCE S86°58'06"E 559.58' TO A 1/2" REBAR, THENCE S86°57'53"E 575.74' TO A 1/2" REBAR, THENCE S86°57'53"E 210.00' TO A 1/2" REBAR CAPPED(CA-497-LS), THENCE S03°26'20"E 202.87' TO A 1 1/2" REBAR AT AN OLD FENCE LINE, THENCE ALONG SAID OLD FENCE LINE THE FOLLOWING CHORD BEARINGS AND DISTANCES: THENCE S15°15'38"W 221.40' TO A POINT, THENCE S09°31'55"W 206.19' TO A POINT, THENCE S01°04'38"W 697.64' TO A POINT, THENCE S01°31'28"E 159.20' TO A POINT, THENCE S02°08'46"E 80.87' TO A 1/2" REBAR AT A FENCE CORNER, THENCE LEAVING SAID OLD FENCE LINE N86°34'55"W 2594.16' TO A 1/2" REBAR CAPPED(CA-497-LS), THENCE N00°03'41"E 668.64' TO A 1/2" REBAR CAPPED(SKIPPER), THENCE N00°03'41"E 334.47' TO A 1/2" REBAR CAPPED(SKIPPER), THENCE N00°03'41"E 334.55' TO A 1/2" REBAR CAPPED(CA-497-LS), THENCE N82°27'47"W 100.47' TO A 1/2" REBAR ON THE EASTERLY R/W OF JAKE MINTZ ROAD (40' R/W), THENCE LEAVING SAID R/W N82°14'53"W 42.03' TO THE POINT OF BEGINNING, CONTAINING 93.82 ACRES MORE OR LESS.

LESS AND EXCEPT ANY PORTION LYING WITHIN THE R/W OF JAKE MINTZ ROAD (40' R/W).  
Legal Description provided by Engineer Larry Walker.

Section 3. The zoning of this property will be R-3, Multi-Family Residential. Said property lies within Calhoun County and is contiguous with the city of Southside current city limits.

Section 4. This ordinance shall be published as provided by law, and a certified copy of same, together with a certified copy of the petition of the property owners, shall be filed with the Probate Judge of Calhoun, Alabama.

Section 5. This territory described in this ordinance shall become a part of the corporate limits of Southside, Alabama, upon publication of this ordinance.

THIS ANNEXATION ORDINANCE IS DULY ADOPTED BY THE SOUTHSIDE CITY COUNCIL THIS THE 13<sup>TH</sup> DAY OF JANUARY, 2020.

Wally Burns  
Mayor Wally Burns

Joey Jones  
Council Member: Joey Jones

Danny Garnett  
Council Member: Danny Garnett

Don Steward  
Council Member: Don Steward

John Hatley  
Council Member: John Hatley

Dana Snyder  
Council Member: Dana Snyder

ATTEST:

Cynthia B. Osborne  
Cynthia B. Osborne, City Clerk

**CERTIFICATION OF ADOPTION**

I hereby certify that the attached ordinance was duly adopted by the Southside City Council in regular session assembled on the 13<sup>th</sup> day of January, 2020 and is recorded in the official minutes of the Southside City Council.

Cynthia B. Osborne  
Cynthia B. Osborne, City Clerk

**CERTIFICATION OF PUBLICATION**

I, Cynthia B. Osborne, City Clerk for the City of Southside, Alabama, do hereby certify that this Ordinance was posted in three public places within the city, and at the Southside City Hall, beginning on the 14<sup>th</sup> day of January, 2020 in accordance with the provisions of Code of Alabama, 1975, Section 11-45-8.

Date: 1-14-2020

Cynthia B. Osborne  
Cynthia B. Osborne, City Clerk

